



UL 248-2

STANDARD FOR SAFETY

Low-Voltage Fuses – Part 2: Class C Fuses

ULNORM.COM : Click to view the full PDF of UL 248-2 2024

[ULNORM.COM](https://ulnorm.com) : Click to view the full PDF of UL 248-2 2024

UL Standard for Safety for Low-Voltage Fuses – Part 2: Class C Fuses, UL 248-2

Second Edition, Dated August 1, 2000

Summary of Topics

This revision of ANSI/UL 248-2 dated March 20, 2024 is being issued to update the title page to reflect the most recent designation as a Reaffirmed American National Standard (ANS). No technical changes have been made.

As noted in the Commitment for Amendments statement located on the back side of the title page, ULSE, CSA, and ANCE are committed to updating this harmonized standard jointly. However, the revision pages dated March 20, 2024 will not be jointly issued by ULSE, CSA, and ANCE as these revision pages only address ULSE ANSI approval dates.

Text that has been changed in any manner or impacted by ULSE's electronic publishing system is marked with a vertical line in the margin.

The requirements are substantially in accordance with Proposal(s) on this subject dated February 2, 2024.

All rights reserved. No part of this publication may be reproduced, stored in a retrieval system, or transmitted in any form by any means, electronic, mechanical photocopying, recording, or otherwise without prior permission of ULSE Inc. (ULSE).

ULSE provides this Standard "as is" without warranty of any kind, either expressed or implied, including but not limited to, the implied warranties of merchantability or fitness for any purpose.

In no event will ULSE be liable for any special, incidental, consequential, indirect or similar damages, including loss of profits, lost savings, loss of data, or any other damages arising out of the use of or the inability to use this Standard, even if ULSE or an authorized ULSE representative has been advised of the possibility of such damage. In no event shall ULSE's liability for any damage ever exceed the price paid for this Standard, regardless of the form of the claim.

Users of the electronic versions of UL's Standards for Safety agree to defend, indemnify, and hold ULSE harmless from and against any loss, expense, liability, damage, claim, or judgment (including reasonable attorney's fees) resulting from any error or deviation introduced while purchaser is storing an electronic Standard on the purchaser's computer system.

No Text on This Page

ULNORM.COM : Click to view the full PDF of UL 248-2 2024

I



Association of Standardization and Certification
NMX-J-009/248/2-ANCE-2000
First Edition



CSA Group
CAN/CSA-C22.2 No. 248.2-00
Second Edition

I



ULSE Inc.
UL 248-2
Second Edition

Low-Voltage Fuses – Part 2: Class C Fuses

August 1, 2000

(Title Page Reprinted: March 20, 2024)



ANSI/UL 248-2-2005 (R2024)



Commitment for Amendments

This standard is issued jointly by the Association of Standardization and Certification (ANCE), the Canadian Standards Association (operating as "CSA Group"), and ULSE Inc. (ULSE). Comments or proposals for revisions on any part of the standard may be submitted to ANCE, CSA Group, or ULSE at anytime. Revisions to this standard will be made only after processing according to the standards development procedures of ANCE, CSA Group, and ULSE. CSA Group and ULSE will issue revisions to this standard by means of a new edition or revised or additional pages bearing their date of issue. ANCE will incorporate the same revisions into a new edition of the standard bearing the same date of issue as the CSA Group and ULSE pages.

Copyright © 2005 ANCE

Rights reserved in favor of ANCE.

ISBN 1-55324-228-9 © 2000 Canadian Standards Association

All rights reserved. No part of this publication may be reproduced in any form whatsoever without the prior permission of the publisher.

This Standard is subject to review within five years from the date of publication, and suggestions for its improvement will be referred to the appropriate committee. To submit a proposal for change, please send the following information to inquiries@csagroup.org and include "Proposal for change" in the subject line: Standard designation (number); relevant clause, table, and/or figure number; wording of the proposed change; and rationale for the change.

To purchase CSA Group Standards and related publications, visit CSA Group's Online Store at www.csagroup.org/store/ or call toll-free 1-800-463-6727 or 416-747-4044.

Copyright © 2024 ULSE INC.

Our Standards for Safety are copyrighted by ULSE Inc. Neither a printed nor electronic copy of a Standard should be altered in any way. All of our Standards and all copyrights, ownerships, and rights regarding those Standards shall remain the sole and exclusive property of ULSE Inc.

This ANSI/UL Standard for Safety consists of the Second Edition including revisions through March 20, 2024. The most recent designation of ANSI/UL 248-2 as a Reaffirmed American National Standard (ANS) occurred on March 20, 2024. ANSI approval for a standard does not include the Cover Page, Transmittal Pages, Title Page (front and back), or the Preface.

Comments or proposals for revisions on any part of the Standard may be submitted to ULSE at any time. Proposals should be submitted via a Proposal Request in ULSE's Collaborative Standards Development System (CSDS) at <https://csds.ul.com>

For information on ULSE Standards, visit <http://www.shopulstandards.com>, call toll free 1-888-853-3503 or email us at ClientService@shopULStandards.com.

CONTENTS

| | |
|--|----------|
| Preface | 5 |
| 1 General | 7 |
| 1.1 Scope | 7 |
| 4 Classification | 7 |
| 5 Characteristics | 7 |
| 5.2 Voltage rating | 7 |
| 5.3 Current rating | 7 |
| 5.5 Interrupting rating | 7 |
| 5.6 Peak let-through current and clearing I^2t characteristics | 7 |
| 7 Construction | 8 |
| 7.1 Dimensions | 8 |
| 8 Tests | 12 |
| 8.1 General | 12 |
| 8.2 Verification of temperature rise and current-carrying capacity | 12 |
| 8.3 Verification of overload operation | 13 |
| 8.4 Verification of operation at rated voltage | 13 |
| 8.5 Verification of peak let-through current and clearing I^2t characteristics | 13 |

ULNORM.COM : Click to view the full PDF of UL 248-2 2024

No Text on This Page

ULNORM.COM : Click to view the full PDF of UL 248-2 2024

Preface

This is the common ULSE, CSA, and ANCE Standard for *Low-Voltage Fuses – Part 2: Class C Fuses*. This is the second edition of CAN/CSA-C22.2 No. 248.2-00 (superseding the first edition, published in 1996), the second edition of UL 248-2, and the first edition of NMX-J-009/248/2-2000-ANCE.

This Standard was prepared by a Technical Harmonization Committee comprised of members from ULSE, CSA International, the National Association of Standardization and Certification of the Electrical Sector, the end product manufacturers, and material suppliers. The efforts and support of the members of the Technical Harmonization Committee are gratefully acknowledged.

The present Mexican Standard was developed by the TC 32 Fuses from the Comité de Normalización de la Asociación de Normalización y Certificación, A.C., CONANCE, with the collaboration of the fuse manufacturers and users.

This Standard was reviewed by the CSA Subcommittee on Fuses and approved by the Technical Committee on Industrial Products under the jurisdiction of the CSA Strategic Steering Committee on the Requirements for Electrical Safety.

Note: Although the intended primary application of this Standard is stated in its Scope, it is important to note that it remains the responsibility of the users of the Standard to judge its suitability for their particular purpose.

Level of Harmonization

This trinational standard is published as an Identical Standard. An identical standard is a standard that is the same in technical content except for conflicts in Codes and Governmental Regulations. Presentation is word for word except for editorial changes.

Interpretations

The interpretation by the SDO (Standards Development Organization) of an identical standard shall be based on the literal text to determine compliance with the standard in accordance with the procedural rules of the SDO. If more than one interpretation of the literal text has been identified, a revision shall be proposed as soon as possible to each of the SDOs to more accurately reflect the intent.

No Text on This Page

ULNORM.COM : Click to view the full PDF of UL 248-2 2024

Low-Voltage Fuses – Part 2: Class C Fuses

1 General

NOTE –

This Part is intended to be read together with the Standard for Low-Voltage Fuses – Part 1: General Requirements, hereafter referred to as Part 1. The numbering of the Clauses in this Part corresponds to like numbered Clauses in Part 1. The requirements of Part 1 apply unless modified by this Part. For Clauses not shown below, refer to the Standard for Low-Voltage Fuses – Part 1: General Requirements, NMX-J-009/248/2-2000-ANCE ♦ CAN/CSA C22.2 No. 248.1 ♦ UL 248-1.

1.1 Scope

This Part applies to Class C fuses rated 1200 A or less and 600 V ac. DC ratings are optional.

4 Classification

Class C fuses are non-renewable with an interrupting rating of 200,000 A. Class C fuses are divided into eight body sizes. The maximum current rating, I_n , for each size is specified in this Part.

5 Characteristics

5.2 Voltage rating

For AC, the rating shall be 600 V ac.

The DC voltage rating may be different from the AC rating.

5.3 Current rating

Refer to [Figure A](#) for range of current ratings in each body size.

5.5 Interrupting rating

For AC – 200,000 A.

For DC, the preferred ratings are 10,000, 20,000, 50,000, 100,000, 150,000, or 200,000 A.

5.6 Peak let-through current and clearing I^2t characteristics

Maximum values of peak let-through current and clearing I^2t are given in [Table A](#).

Table A
Maximum peak let-through current and clearing I^2t for Class C fuses at 200 kA

| Current rating I_n , A | Peak let-through current, A | I^2t , ampere-squared seconds |
|--------------------------|-----------------------------|---------------------------------|
| 0 – 30 | 12,000 | 15,000 |
| 31 – 60 | 20,000 | 60,000 |
| 61 – 100 | 30,000 | 200,000 |
| 101 – 200 | 40,000 | 750,000 |
| 201 – 400 | 70,000 | 4,000,000 |
| 401 – 600 | 100,000 | 10,000,000 |
| 601 – 800 | 115,000 | 25,000,000 |
| 801 – 1200 | 125,000 | 40,000,000 |

7 Construction

7.1 Dimensions

Fuse dimensions are shown in [Figure A](#).

Figure A
Dimensions of Class C fuses in mm

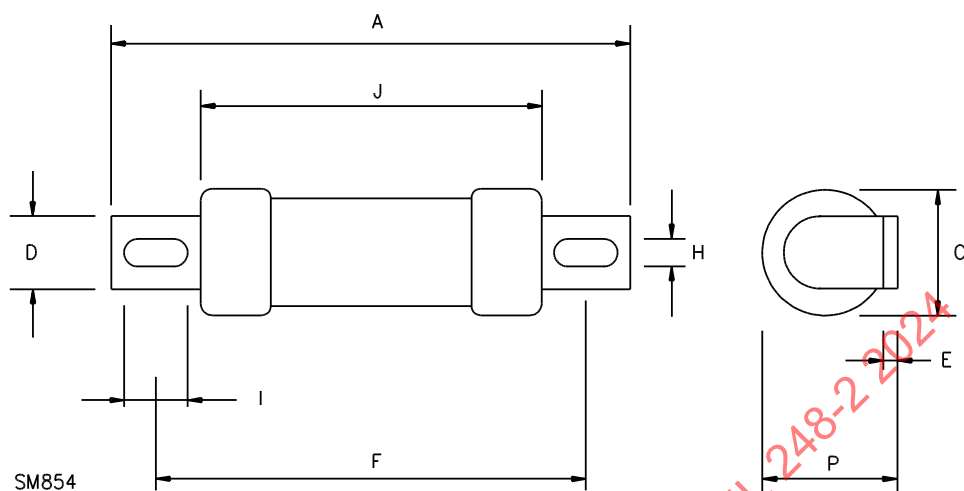

0 – 100 A

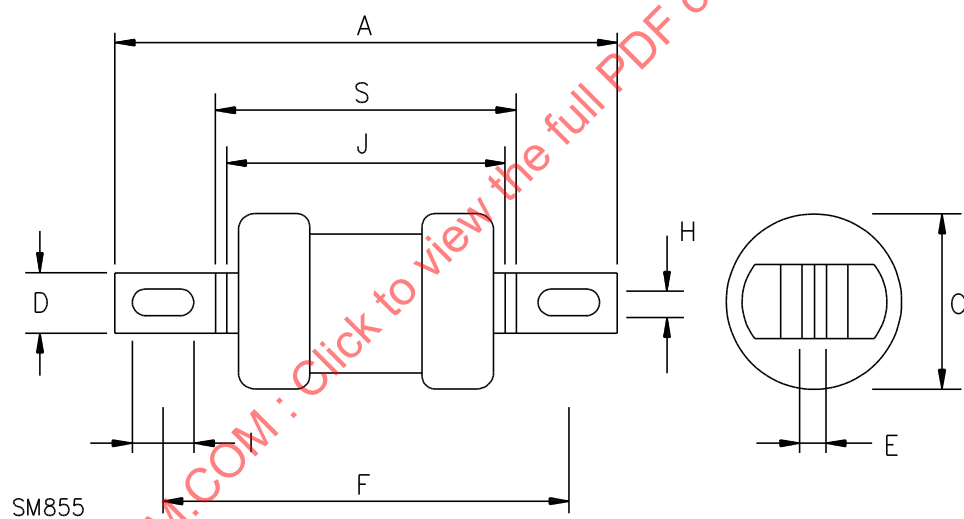

101 – 200 A

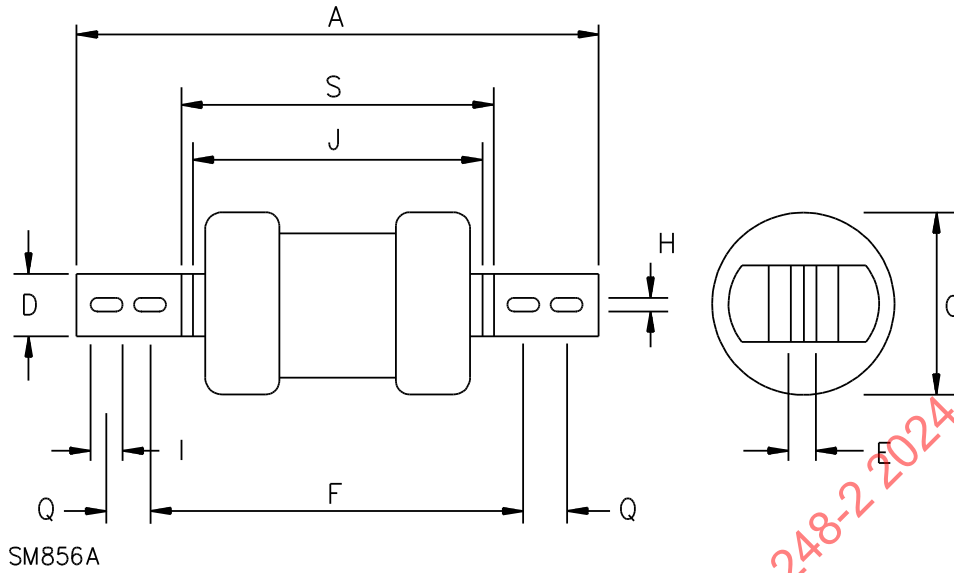

201 – 800 A

ULNORM.COM : Click to view the full PDF of UL 248-2 2024